

# SUNROOF UNIT DISASSEMBLY/ASSEMBLY

B3E091569850W03

1. Disassemble in the order indicated in the table.

2. Assemble in the reverse order of disassembly.

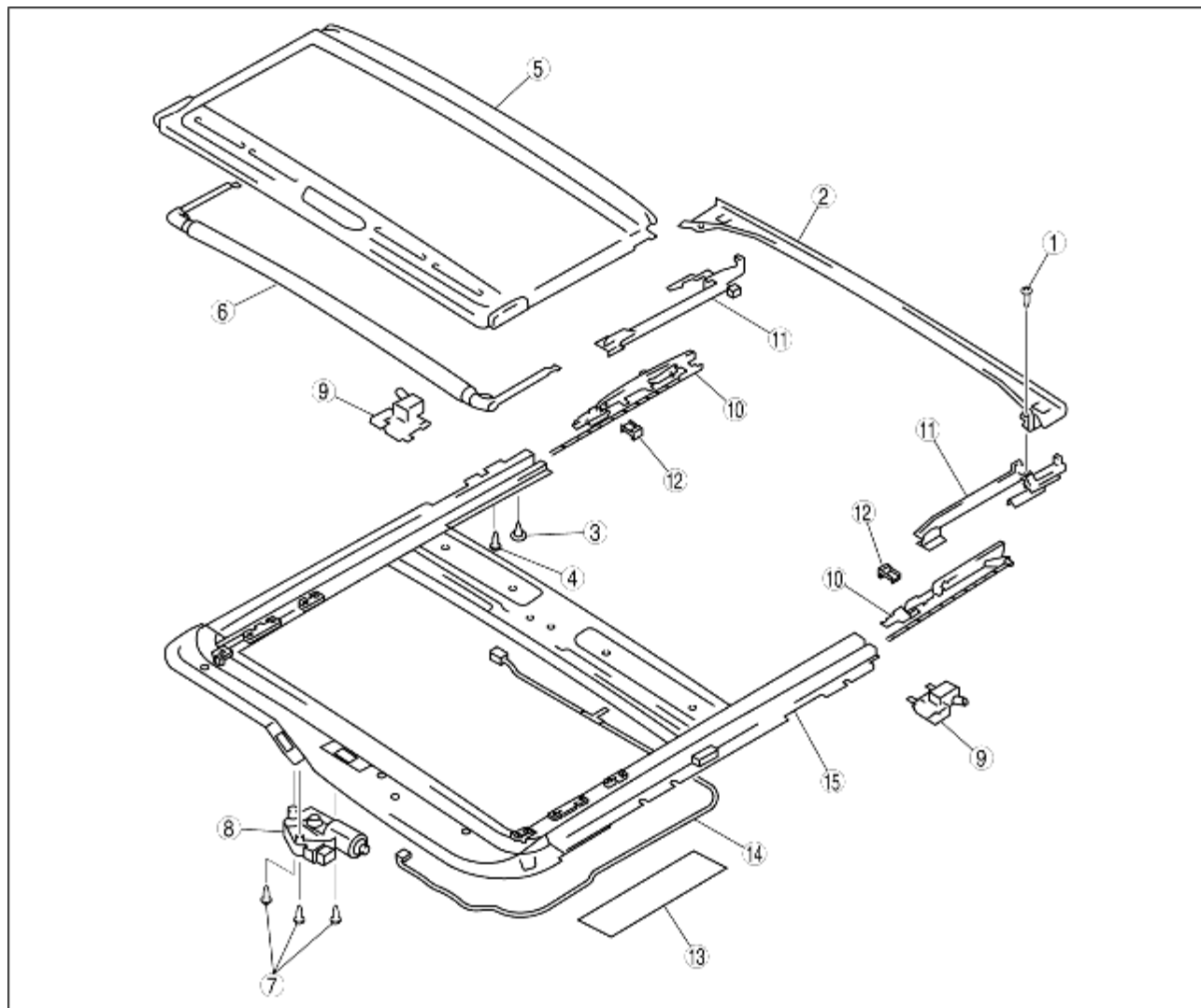

B3E0915W108

1	Screw A
2	Drip rail
3	Sunshade stopper
4	Screw B
5	Sunshade
6	Deflector
7	Screw C
8	Sunroof motor (See <a href="#">Sunroof Motor Assembly Note.</a> )

9	Rear drip (See <a href="#">Rear Drip Assembly Note.</a> )
10	Guide
11	Decoration link
12	Front drip
13	Tape protector
14	Short cord
15	Frame

## Rear Drip Assembly Note

### Note

- If the rear drip is removed, butyl seal must be applied when re-installing.

1. Apply a **6.0-8.0 mm {0.24-0.31 in}** wide line of butyl seal to the area shown in the figure.

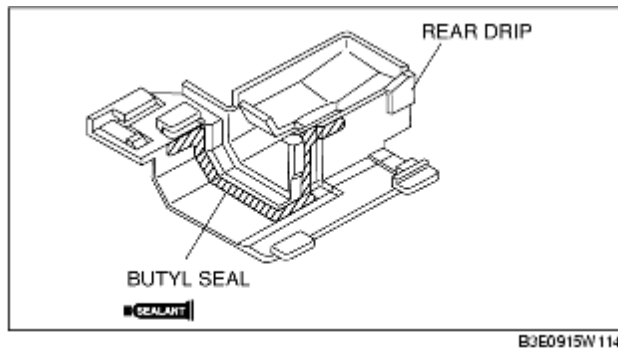

## Sunroof Motor Assembly Note

### Note

- If the guide is removed, initial position setting of the sunroof motor will be required. After installing the sunroof unit, perform initial position setting using the following procedure.

1. Press the TILT UP switch to fully tilt up the glass panel.
2. When the glass panel reaches the fully tilt up position, temporarily release the TILT UP switch and press it again **for approx. 13 s** continuously. Continue pressing the switch until the glass panel automatically stops at the fully tilt up position after reaching the mechanical lock position.
3. When the glass panel stops at the fully tilt up position, temporarily release the TILT UP switch, then press it again **within 5 s** and hold.

### Note

- Press the TILT UP switch continuously until the glass panel opens to the fully open position, returns to the fully closed position and then stops.

4. Release the TILT UP switch when the glass panel stops at the fully closed position.